

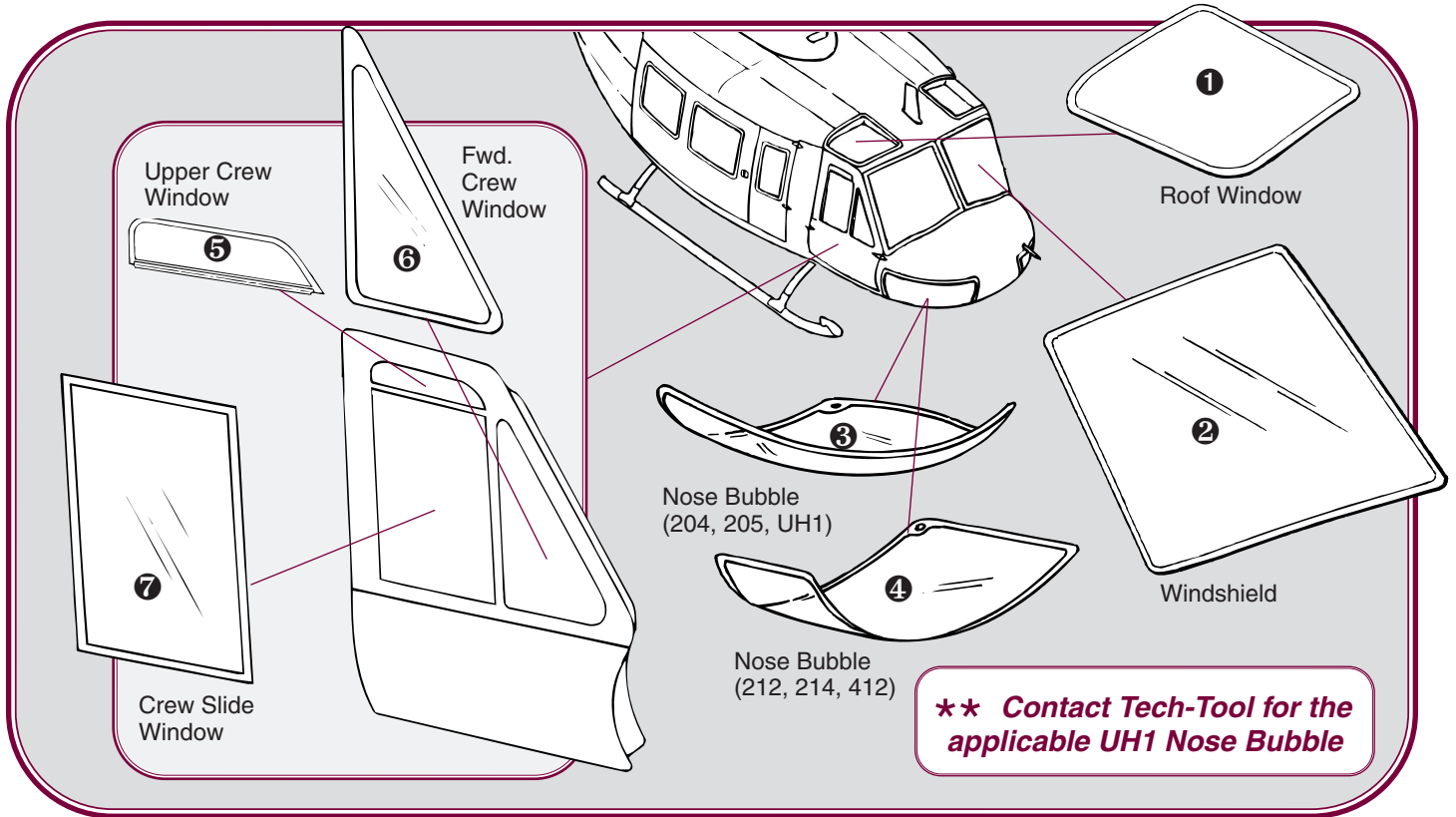

# Bell Model 204, 205, 212, 214, 412, UH1



**\*\* Contact Tech-Tool for the applicable UH1 Nose Bubble**

**1 Roof Window \***

Part Number	Replaces OEM No.	Model No.
204B-1021-1 L/H	204-030-673-29,57	204,UH1B,E,F,L
204B-1021-2 R/H	204-030-673-23,45	204,UH1B,E,F,L
205D-1022-1 L/H	205-030-673-31	214
205D-1022-2 R/H	205-030-673-61,71	214
205D-1022-1B L/H	205-030-673-101	214
205D-1022-2B R/H	205-030-673-102,109	214
205D-1022-3 L/H	205-030-673-23,37	205,212,UH1H
205D-1022-6 R/H	205-030-673-24,38	205,212,UH1H
205D-1022-3B L/H	205-030-673-103	412
205D-1022-6B R/H	205-030-673-104	412

**4 Nose Bubble \***

Part Number	Replaces OEM No.	Model No.
212-1034-1 L/H	212-030-076-1,3	212,214,412
212-1034-2 R/H	212-030-076-2,4	212,214,412

**5 Upper Crew Window (all models) \***

Part Number	Replaces OEM No.
204B-1026-1 L/H	204-030-770-1,101
204B-1026-2 R/H	204-030-770-2,102

**6 Fwd. Crew Window (all models)**

Part Number	Replaces OEM No.
204B-1025-1 L/H	204-030-459-1
204B-1025-2 R/H	204-030-459-2

**2 Windshield (all models) \***

Part Number	Replaces OEM No.
204B-1023-1 L/H	204-030-666-43
204B-1023-2 R/H	204-030-666-44

**3 Nose Bubble \***

Part Number	Replaces OEM No.	Model No. **
204B-1024-1 L/H	204-030-657-35	205,UH1
204B-1024-2 R/H	204-030-657-36	205,UH1
204B-1024-3 L/H	204-030-657-19	204,UH1
204B-1024-4 R/H	204-030-657-20	204,UH1

**7 Crew Slide Window**

Part Number	Replaces OEM No.	Handle
204B-1027-1 L/H -R/H	204-030-799-1	Standard Handle
204B-1027-1 L/H -R/H	204-030-799-101,111	412 Handle

**\*Tech-Tool Exclusive**  
 These windows are manufactured with a "see-through" translucent fiberglass edging that makes locating the attach holes easier and drilling more accurate. The result is a faster and more economical window installation.



**TECH-TOOL PLASTICS, INC.**

7800 Skyline Park Drive • Fort Worth, Texas 76108 • www.tech-tool.com

# Bell Model 204, 205, 212, 214, 412, UH1

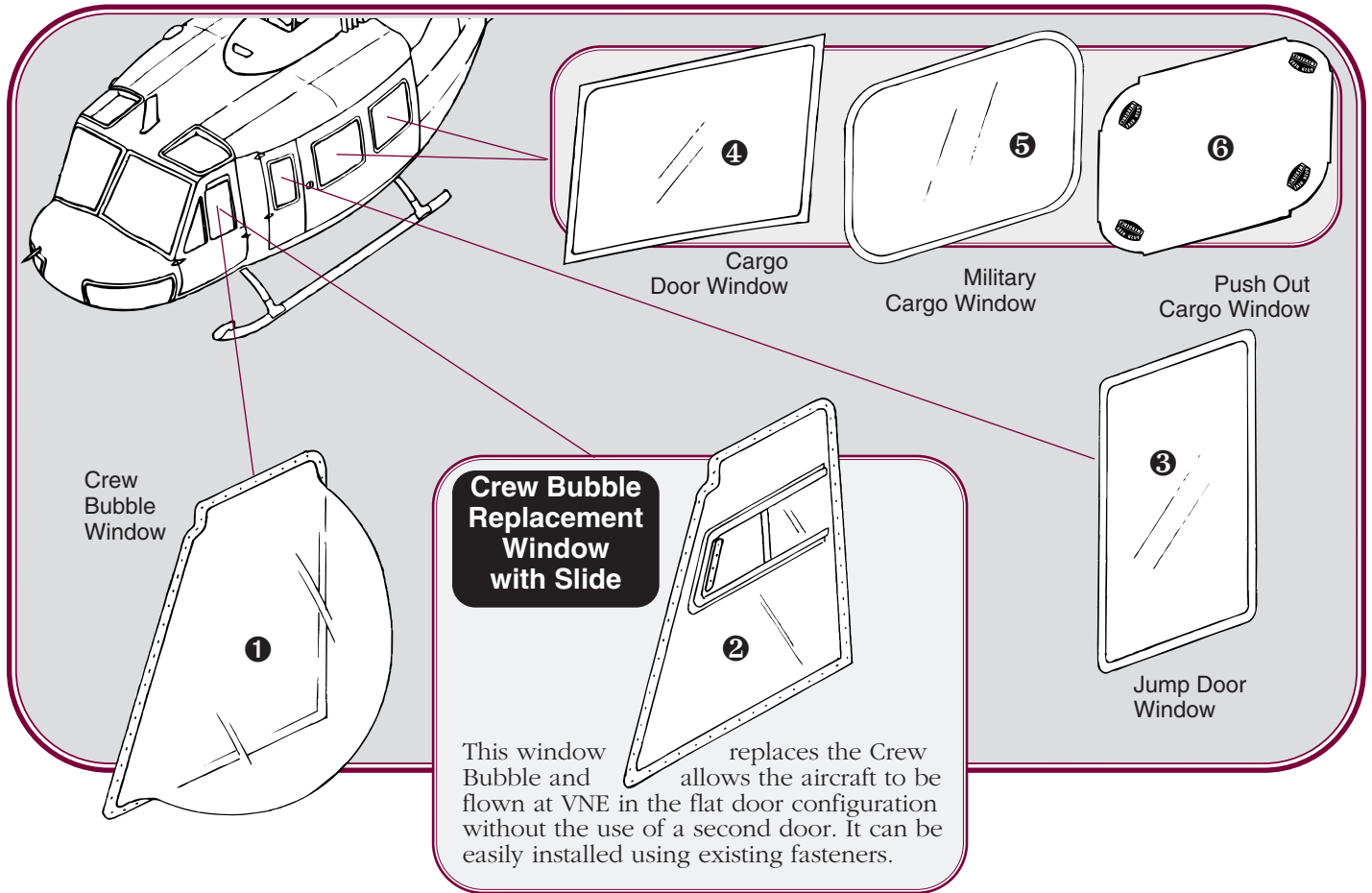

**1 Crew Bubble Window**

Part Number	Replaces OEM No.
204B-1033-1	Tech-Tool Design

**2 Replacement Window with Slide**

Part Number	Replaces OEM No.
204B-1035-1	Tech-Tool Design

**3 Jump Door Window**

Part Number	Replaces OEM No.
205D-1028-1	L/H 205-030-285-1
205D-1028-2	R/H 205-030-285-2
412-1028-1	L/H 412-030-051-101 **
412-1028-2	R/H 412-030-051-102 **

**4 Cargo Door Window \***

Part Number	Replaces OEM No.
205D-1031-1	205-032-713-5

**5 Military Cargo Window \***

Part Number	Replaces OEM No.
205D-1029-1	205-031-669-7

**6 Push Out Cargo Window**

Part Number	Replaces OEM No.
214B-1030-1	205-032-669-233
412-1030-1	412-030-308-137 **

**\*\*** Applicable to Bell model 412 S/N 36191 and up

**\*Tech-Tool Exclusive**  
 These windows are manufactured with a "see-through" translucent fiberglass edging that makes locating the attach holes easier and drilling more accurate. The result is a faster and more economical window installation.

## Replacement Windows for the Helicopter World